

MAYOR STREET UPPER

CASTLEFORBER ROAD

NORTH WALL AVENUE

NORTH WALL QUAY

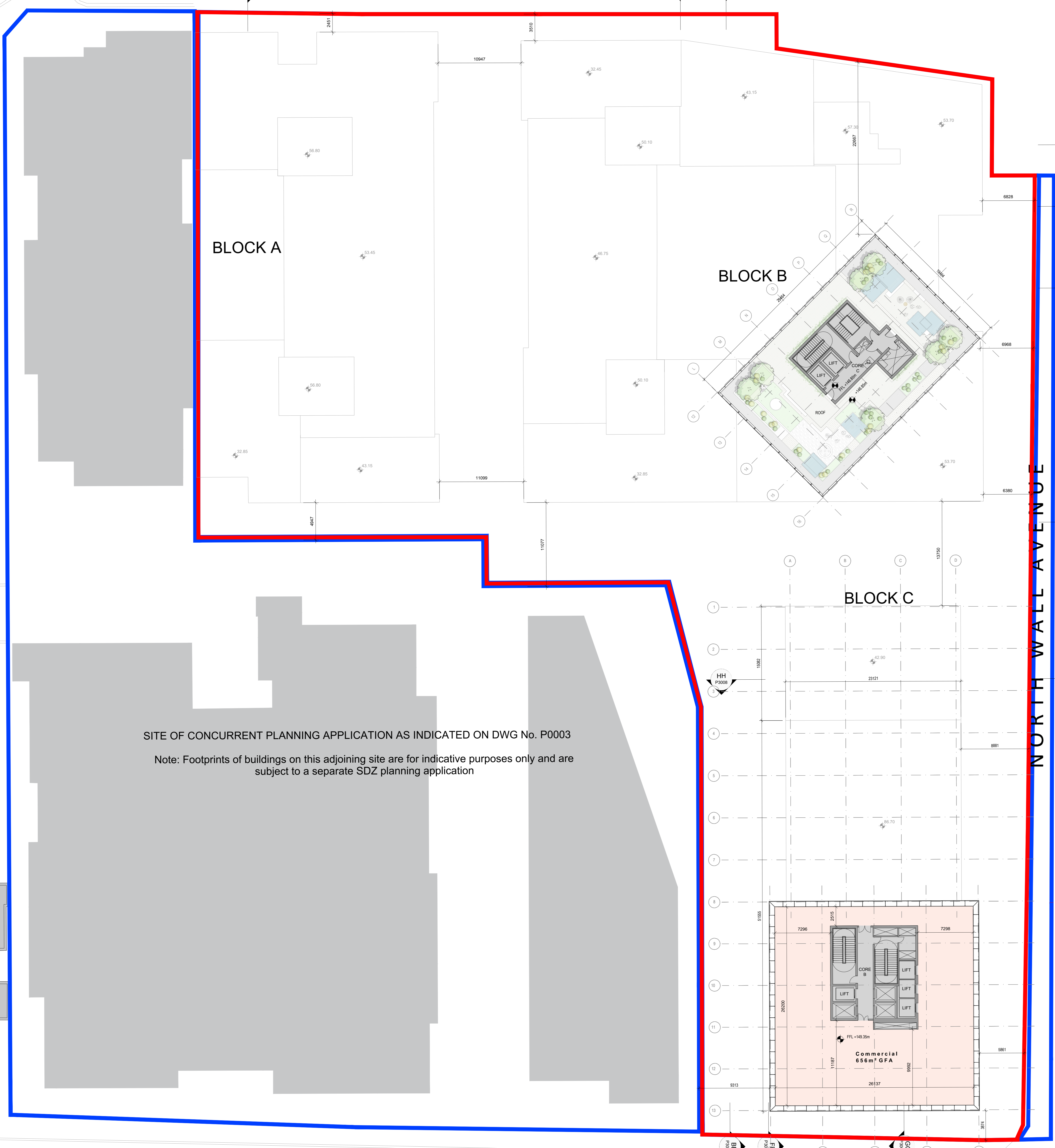

BLOCK A

BLOCK B

BLOCK C

SITE OF CONCURRENT PLANNING APPLICATION AS INDICATED ON DWG No. P0003
 Note: Footprints of buildings on this adjoining site are for indicative purposes only and are subject to a separate SDZ planning application

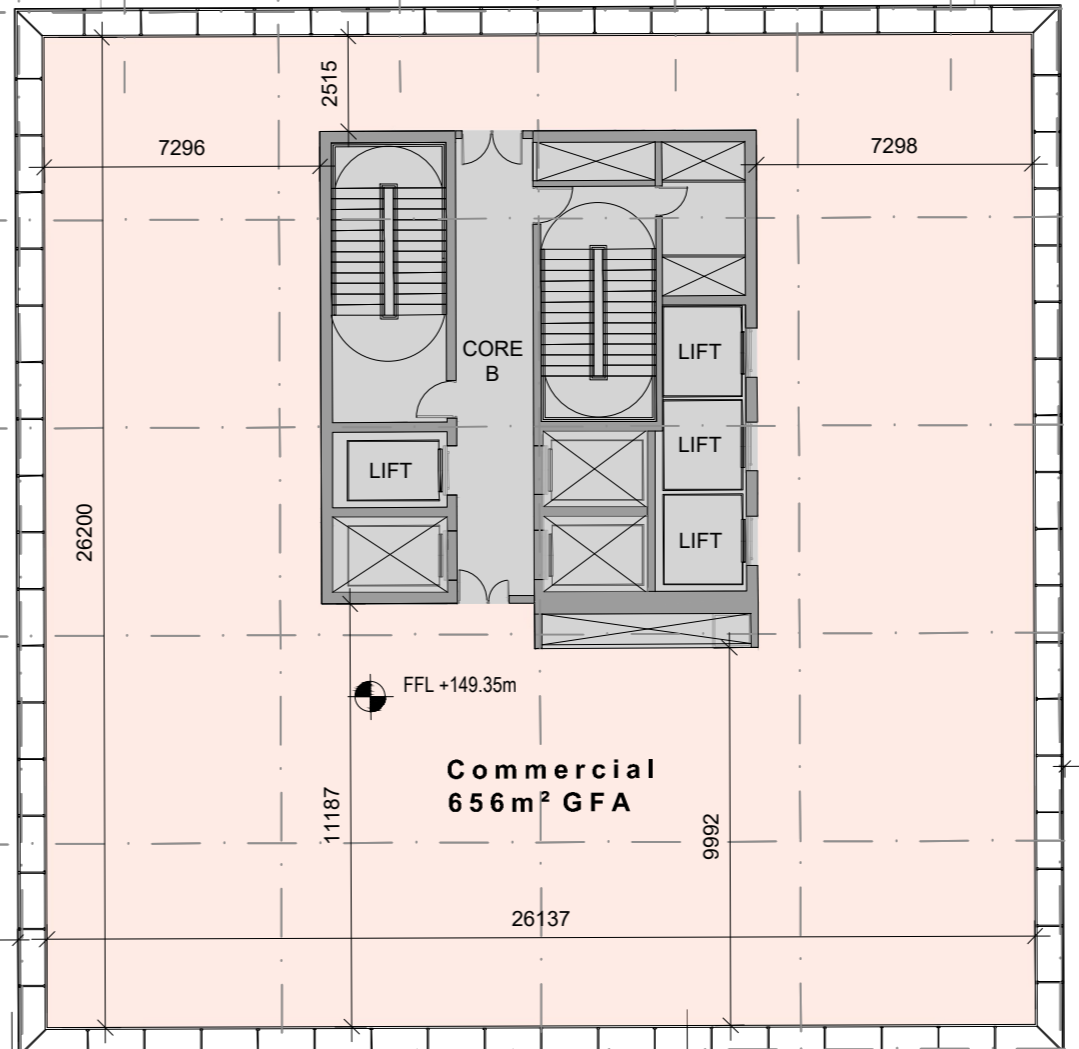

NOTE
 ALL DIMENSIONS TO BE CHECKED ON SITE
 NO DIMENSIONS TO BE SCALED FROM THIS DRAWING
 THIS DRAWING IS TO BE READ IN CONJUNCTION WITH
 RELEVANT CONSULTANTS DRAWINGS
 ANY PROPOSALS EXTERNAL TO THE REDLINE ARE INDICATIVE ONLY.

SHD Planning Application Boundary
 Other lands in ownership of the Applicant

Other Uses/ Office

Refer to Cameo plans for landscape material reference

NOTE:
 - LEVELS SHOWN RELATE TO OS DATUM LEVELS

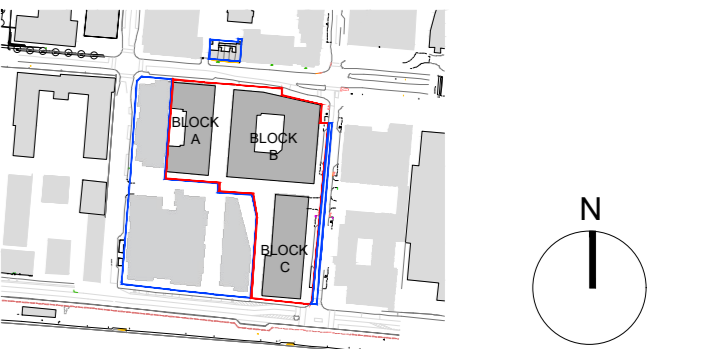

KEY PLAN

NOTE
 ALL DIMENSIONS TO BE CHECKED ON SITE
 NO DIMENSIONS TO BE SCALED FROM THIS DRAWING
 THIS DRAWING IS TO BE READ IN CONJUNCTION WITH
 RELEVANT CONSULTANTS DRAWINGS

REV	DATE	DESCRIPTION	CHKD	DRN
7	15/01/2021	SHD Planning Application	GC	NP
6	08/01/2021	DRAFT SHD Planning Application	GC	NP
5	27/05/2020	ABP Response Issue	GC	NP
4	24/04/2020	Issued for information	GC	NP
3	28/11/2019	SHD Consultation Request	GC	NP
2	21/11/2019	DRAFT SHD Submission	GC	NP
1	12/11/2019	DRAFT SHD Submission	GC	NP

APPLICATION REFERENCE NO.: ABP-306158-19
PLANNING

Henry J Lyons

Architecture + Interiors +353 1 888 3333 51-54 Pearse Street
 henryjlyons.com info@henryjlyons.com Dublin D02 KA66

CLIENT
**Waterside Block 9
 Developments Limited**
 PROJECT
**Waterfront ~South Central~
 SHD Scheme**

JOB NUMBER: 950527
 DATE: January 2021
 SCALE: 1:200@A0
 DRAWN: NP
 CHECKED: GC
 FILE NAME: P 1051 Forty First Floor Plan

Forty First Floor Level 41

BLOCK	DRAWING NUMBER	ZONE	REVISION
	P1051		7